

Morven

Morven is the oldest community in the county. It was here that the first settlers in present Brooks County first came in 1823. The beginnings of Morven go back beyond the building up of the present town; it was in 1826-27 that Hamilton W. Sharpe came from Tatnall County and built a little log store on the Coffee Road near the residence and inn of Sion Hall, a mile or so northeastwardly from present Morven. "Sharpe's Store" post office was soon after established.

The present town had its beginnings shortly before the Civil War. The post office was moved and re-named "Morven" in July, 1853.

Morven was incorporated in 1901. The advent of the South Georgia Railroad in 1897 placed the town on a railroad for the first time. In the years that followed, Morven took a jump in industries and population. There is considerable activity around Morven in such lines as naval stores, sawmilling, pulp-wood operations, and farming including truck farming.

Barney

The Town of Barney dates back only to 1897 when the South Georgia Railroad was built through. The first settlement in this district was made more than a hundred years ago when William Folsom moved here from Irwin County in the 1830's. His home and plantation was near Little River. This land is now known as the Roundtree Place.

A new day dawned with the coming of the railroad. A railroad station was established here and named "Barney" by the Oglesbys in honor of one of the owners of the Barney-Smith Car Company of Ohio from whom the new railroad bought much of its equipment.

The community has kept pace with the surrounding sections in agricultural advancement, planting year-round crops, using modern machinery for cultivating the crops, and trucks to haul the produce to market. At times Barney has been known as "a good cotton market." People hauled their cotton many miles to the gins here to be ginned, baled and sold. The watermelon market was just as good for a long time. At the present time many thousands of pounds of beans and other vegetables are marketed here each year and hauled away in large trucks to cities and canneries.

Pavo

Pavo is located on the county line of Brooks and Thomas counties. Its business section and most of the population is in Thomas County. It is generally known as a Thomas County town, therefore, its history more properly belongs to Thomas County. But some information about its early beginnings will be given here.

Pavo was originally called "McDonald" and was the old antebellum home and plantation of Captain James McDonald who commanded one of the Brooks County companies in the Confederate Army. Until about 1868 it was generally believed Captain McDonald lived in Brooks County but a re-survey placed his residence just over in Thomas County. The original McDonald activities included a community store and gin mill and probably saw mill in addition to the large plantation.

In April 1892, the new railroad then being built from Pidcock northward to Moultrie was completed to McDonald, and a station established there. The coming of the railroad gave considerable impetus to the long-cherished plan of developing a town at McDonald. A number of families quickly moved in, stores were built and a post office established. When the name of the post office was submitted to the Post Office Department it was objected to on account of another post office in Georgia being named McDonald Mill. It remained for Duncan D. Peacock who became the first post master to submit a new name "Pavo" which was the Latinized form of the name "Peacock" and it was adopted.

Barwick

Barwick is another town that is partly in Brooks and partly in Thomas counties. It is located about four miles south of Pavo, and is on the Georgia Northern Railroad whose main track through the town is the county line. The business section of the town is in Brooks County. About half of the residential area of the town is in Thomas County.

Barwick is reached by a paved road from Pavo, also by a paved highway from Quitman completed in 1948. Another paved road runs westward and intersects with the Pavo-Thomasville Road.

Like Pavo, the town had its inception with the new railroad being built in 1891-92.

Barwick is built on lands formerly owned by T. M. Massey and John Massey. The former owned all the land on the Brooks County side of the railroad, and the latter owned the land on the Thomas County side.

Barwick was first incorporated about 1900.

Dixie

Dixie was the successor to old Grooverville. When the A. & G. Railroad was built through in 1860-61 it missed Grooverville a few miles. A station was established and was known as No. 17 "Groover's Station." During the war there was a line of stage coaches which ran between No. 17 and Monticello, Florida, connecting with trains at both points.

About 1869, Jacob Moody, Jr., from Wayne County, built a big sawmill at No. 17, and operated it there several years. This industry later drew several families who bought lots and built homes at Dixie.

The territory around Dixie became a great farming section and for years the railroad depot and sidetrack was the scene each year of much shipping of watermelons, cotton, truck crops, etc. The long string of freight cars on the sidetrack waiting to be loaded, was a familiar scene. This with the lumber cut from the virgin forests, and the naval stores, made Dixie a very busy and prosperous place for many years.

BARWICK

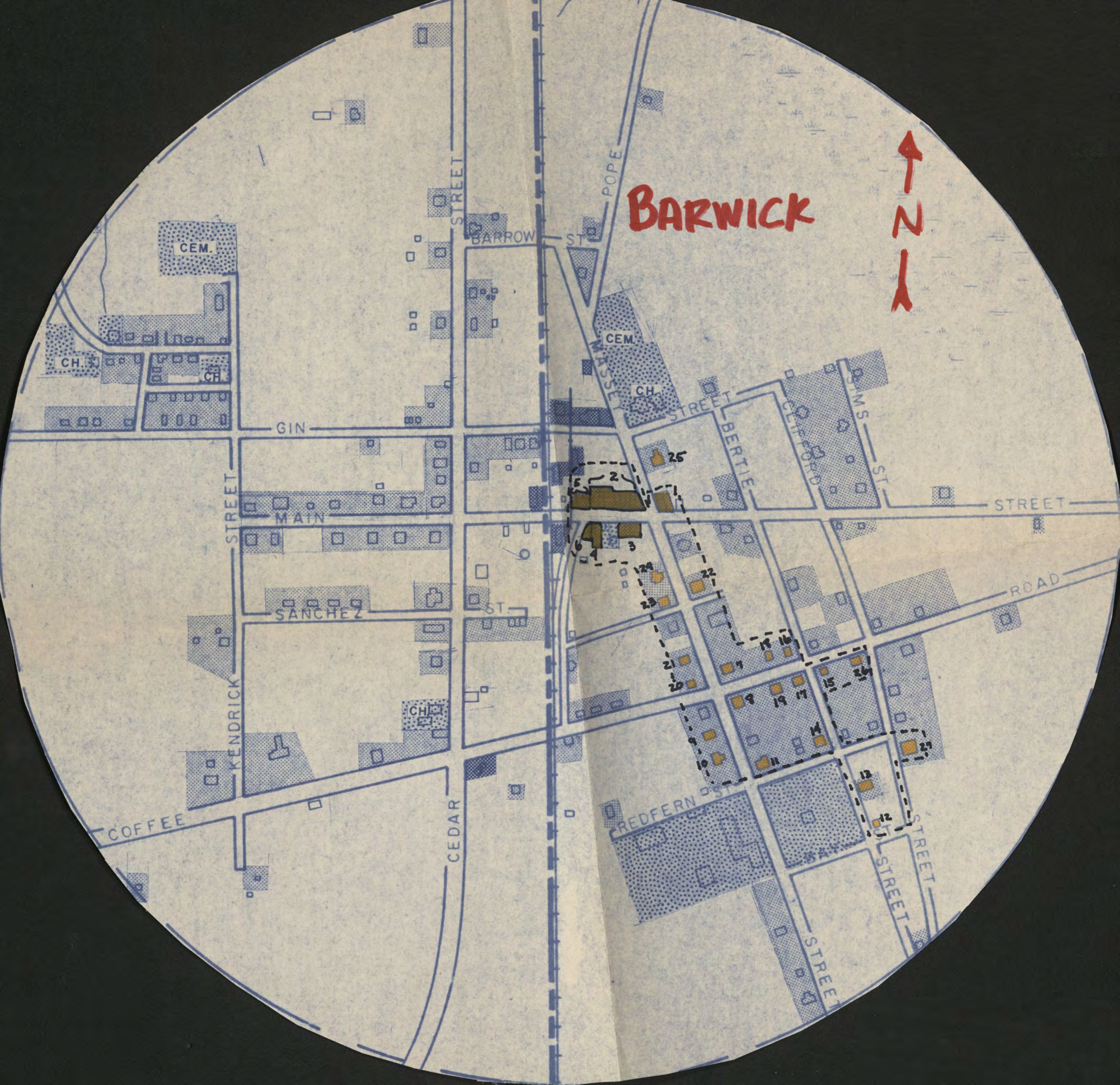

Molven

R.M.D.
800

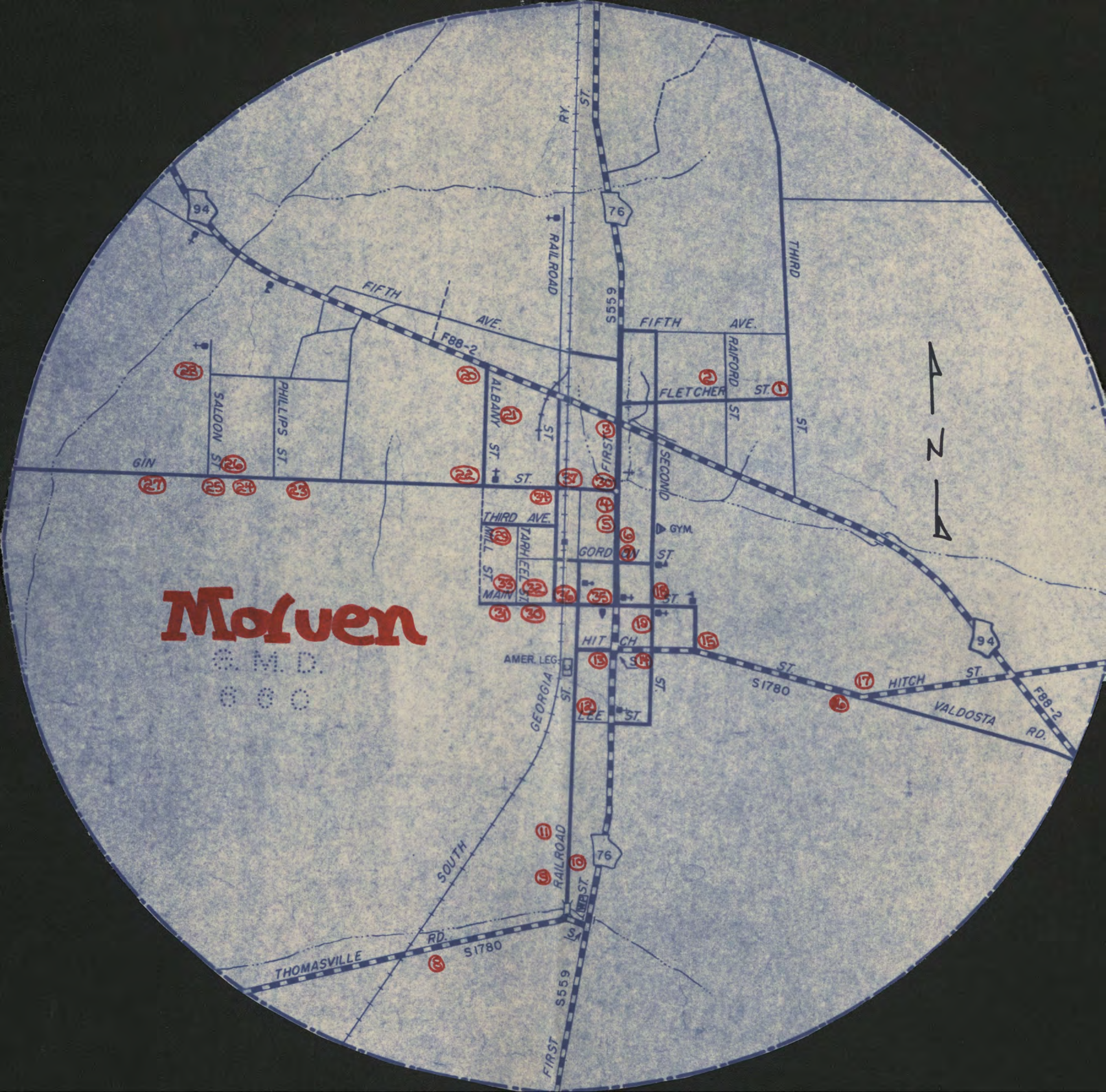
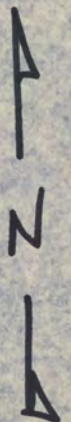

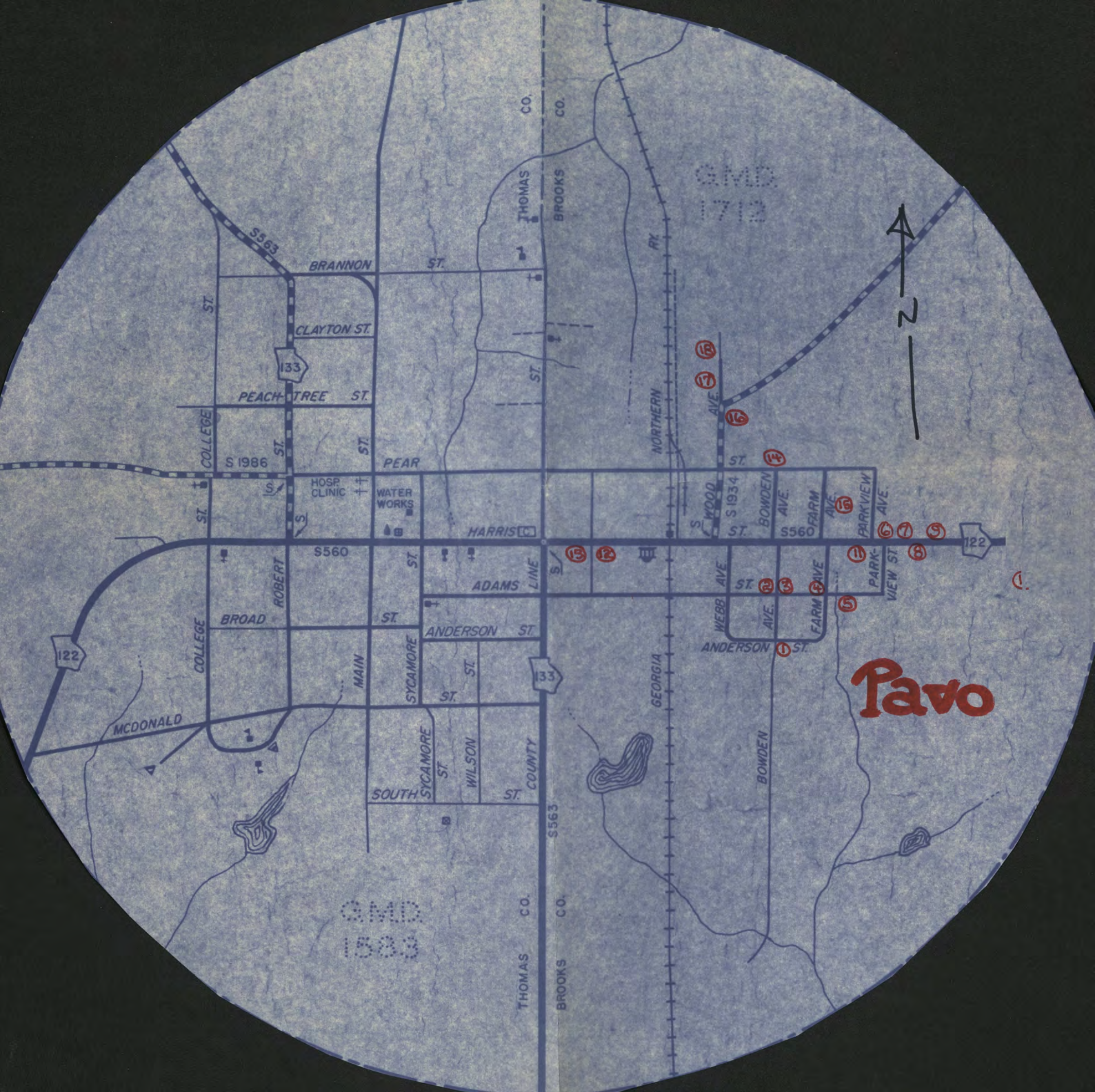

GMD
1712

GMD
1583

Pavo



122

133

133

122

1

2

3

4

5

6

7

8

9

10

11

12

13

14

15

16

17

18

19

20

21

22

23

24

25

26

27

28

29

30

31

32

33

34

35

36

37

38

39

40

41

42

43

44

45

46

47

48

49

50

51

52

53

54

55

56

57

58

59

60

61

62

63

64

65

66

67

68

69

70

71

72

73

74

75

76

77

78

79

80

81

82

83

84

85

86

87

88

89

90

91

92

93

94

95

96

97

98

99

100

101

102

103

104

105

106

107

108

109

110

111

112

113

114

115

116

117

118

119

120

121

122

123

124

125

126

127

128

129

130

131

132

133

134

135

136

137

138

139

140

141

142

143

144

145

146

147

148

149

150

151

152

153

154

155

156

157

158

159

160

161

162

163

164

165

166

167

168

169

170

171

172

173

174

175

176

177

178

179

180

181

182

183

184

185

186

187

188

189

190

191

192

193

194

195

196

197

198

199

200

201

202

203

204

205

206

207

208

209

210

211

212

213

214

215

216

217

218

219

220

221

222

223

224

225

226

227

228

229

230

231

232

233

234

235

236

237

238

239

240

241

242

243

244

245

246

247

248

249

250

251

252

253

254

255

256

257

258

259

260

261

262

263

264

265

266

267

268

269

270

271

272

273

274

275

276

277

278

279

280

281

282

283

284

285

286

287

288

289

290

291

292

293

294

295

296

297

298

299

300

301

302

303

304

305

306

307

308

309

310

311

312

313

314

315

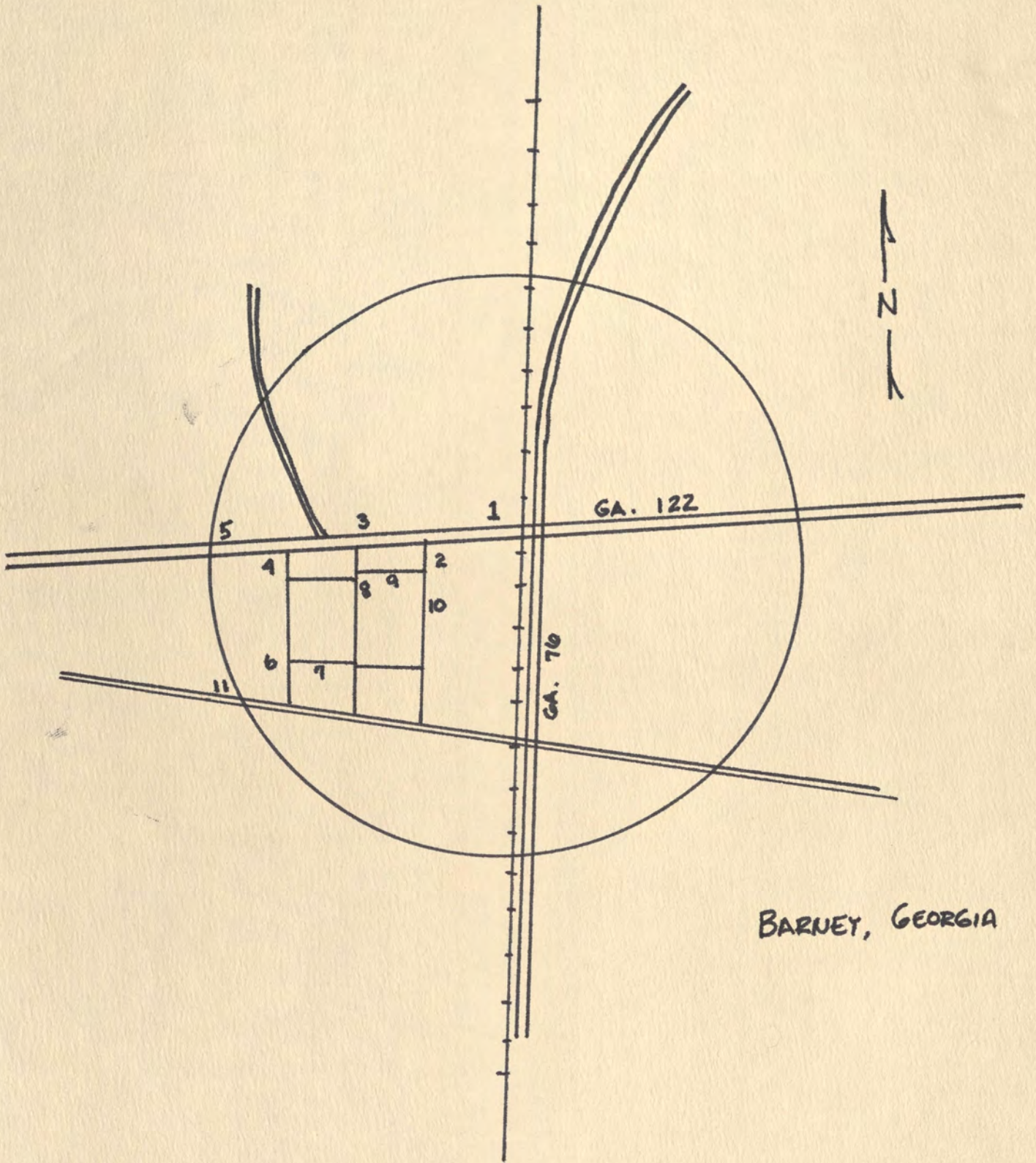

BARNEY, GEORGIA